



Quick detach propeller user and safety guide



Proper Handling of Quick Detach Propellers:

- **Handle propellers with safety and with care.**





- **When walking with or carrying propellers, make sure you carry them down by your side with your arm straight, to prevent injuring yourself if you trip or fall when carrying propellers.**

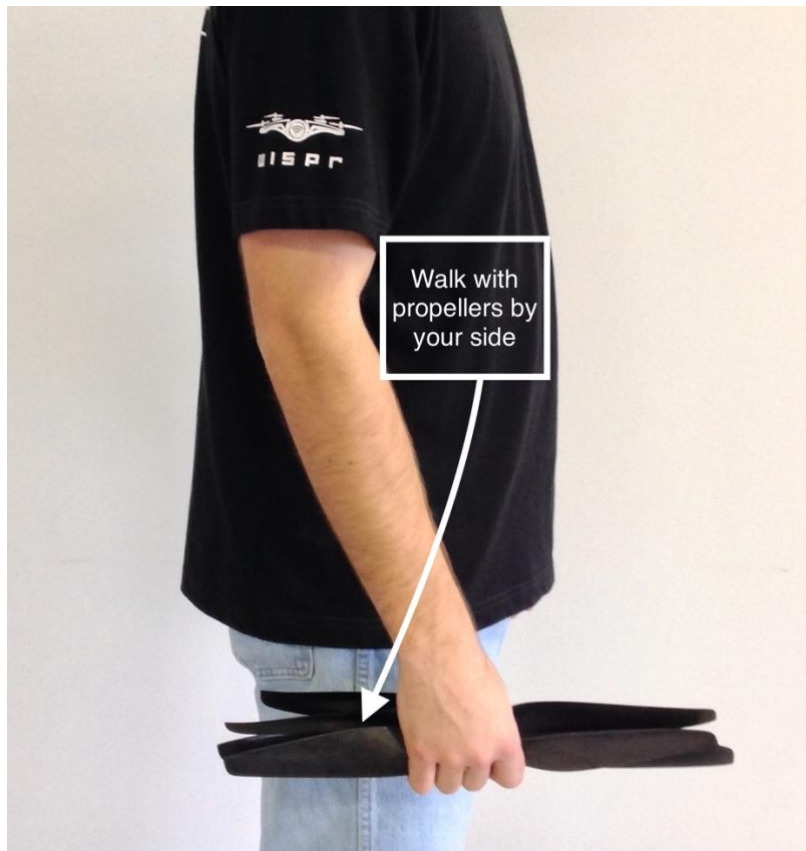

- **Do not handle propellers close to your face or eyes.**
- **Any damage done to the propellers will cause disturbance in the flight and will be a safety hazard. (scratches, nicks, cracks, etc.)**



Putting Propellers on the WISPr Scout:

(1) Confirm propellers bumpers are extended and knobs are tightened

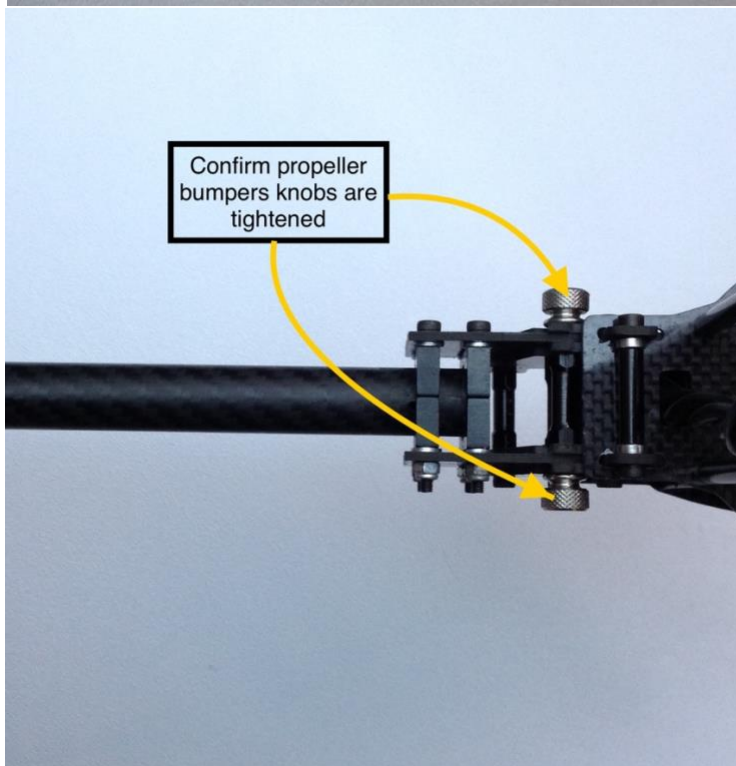
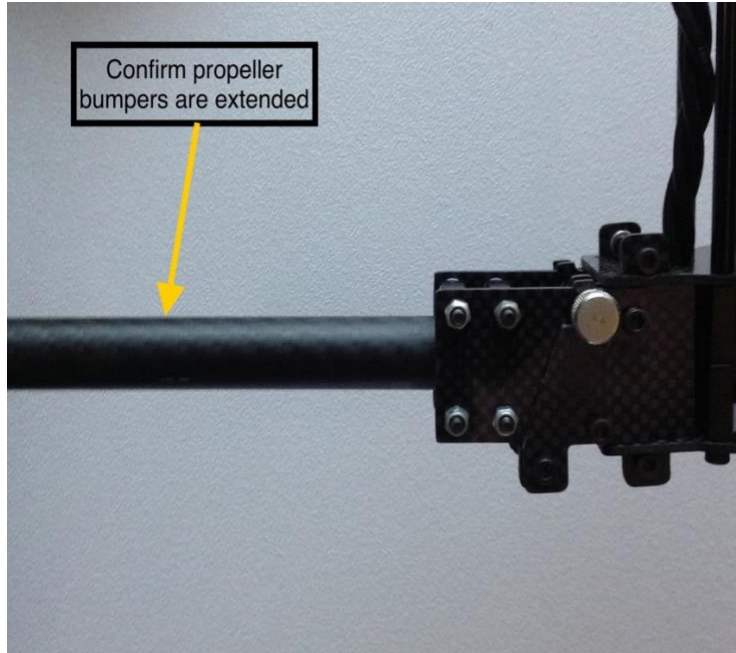



(2) Confirm Battery is unplugged

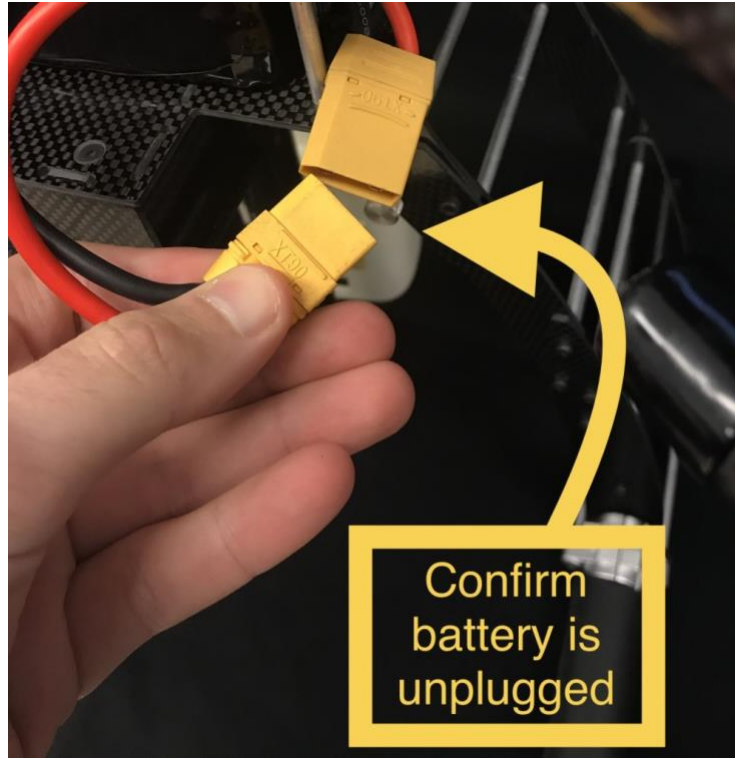



(3) Connect the counter clockwise (CCW) propeller with the orange quick detach to the motor with the orange quick detach attachment.

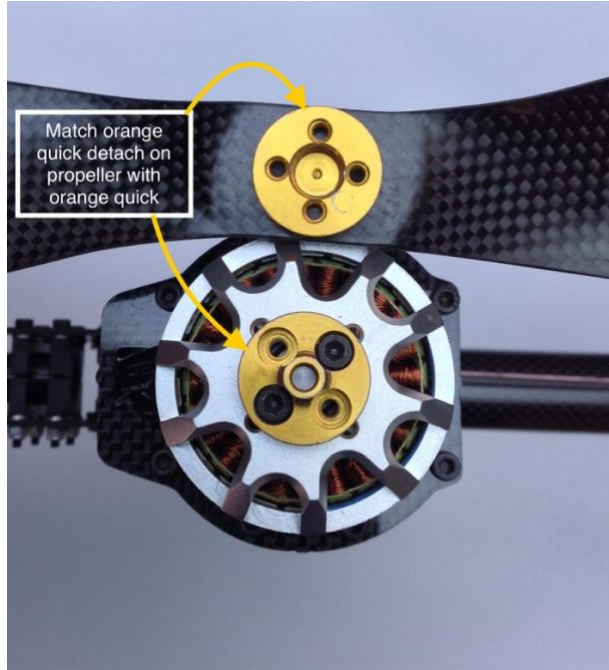

a. Hold the motor still and spin the propeller on the motor clockwise (CW) to get it started.

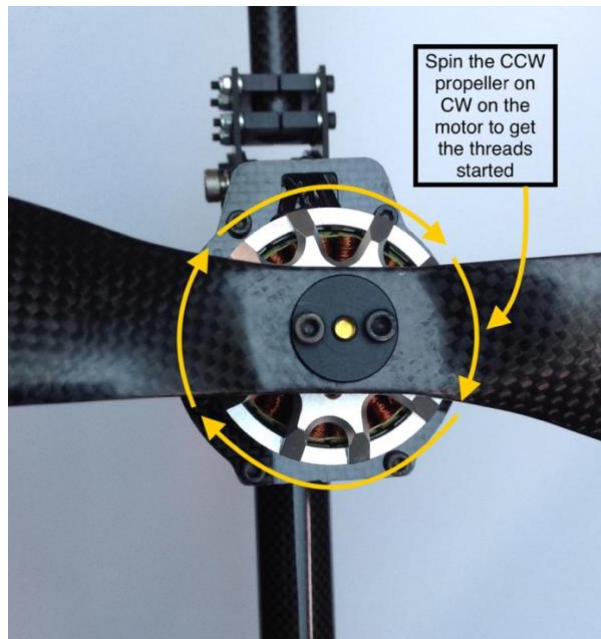



b. After the threads have started, hold the propeller still and spin the motor CCW to tighten the quick detach.

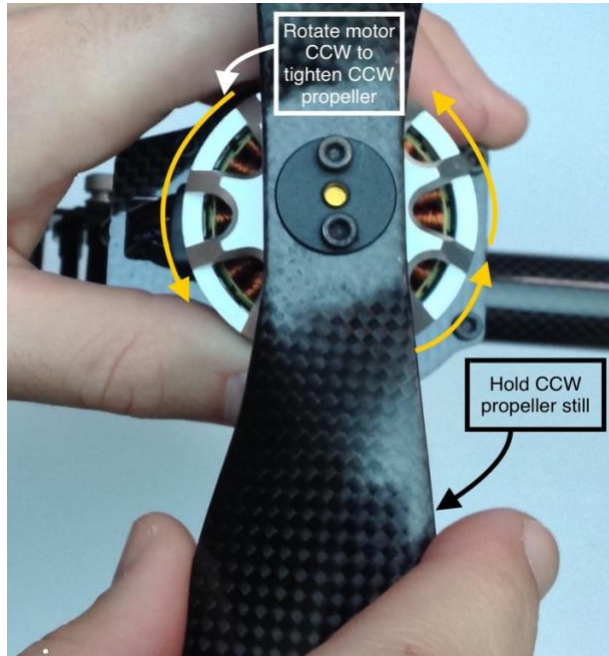

(4) Connect the CW propeller with the silver quick detach to the motor with the silver quick detach attachment.

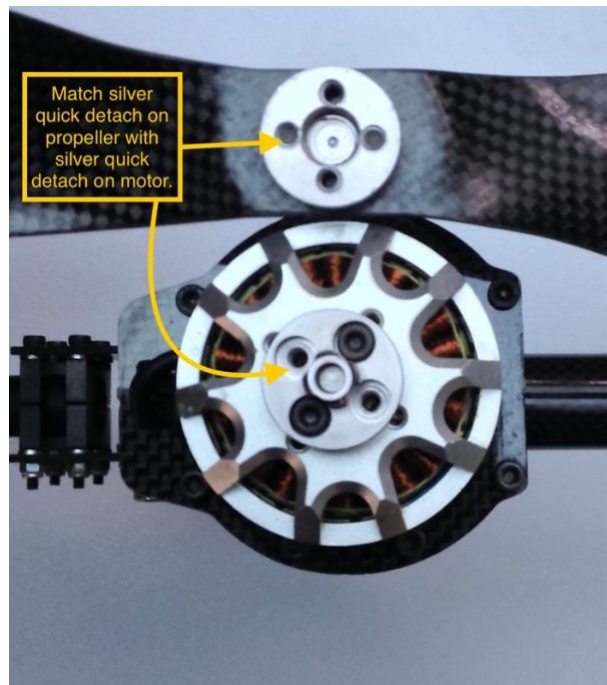



- a. Hold the motor still and spin the propeller on the motor CCW to get it started.**

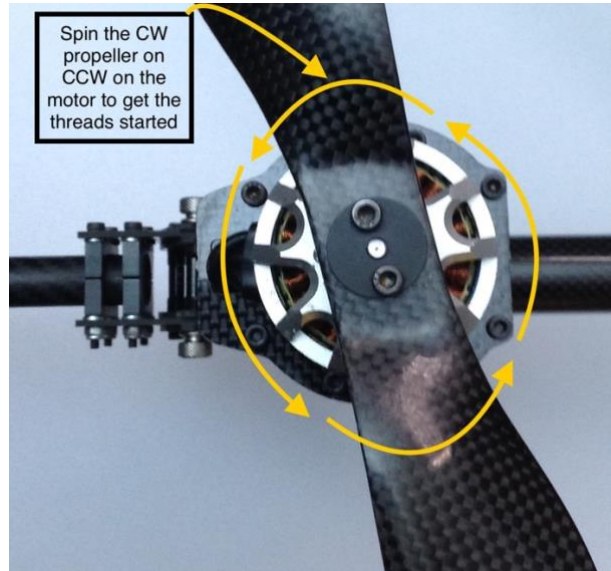

- b. After the threads have started, hold the propeller still and spin the motor CW to tighten the quick detach.**

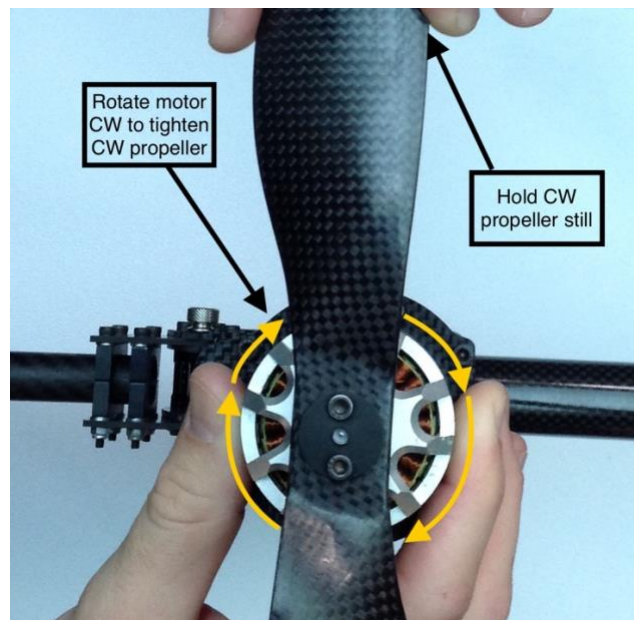



(5) After the propellers are attached to the motors, plug in the battery.

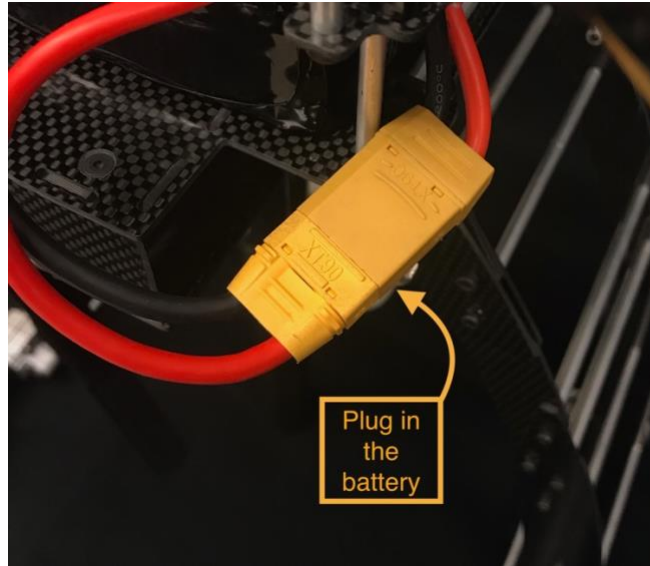



(6) Once the light on top of the GPS begins to blink blue or green, then press and hold the safety switch button until the red light around the button on the GPS begins to blink at a faster rate.

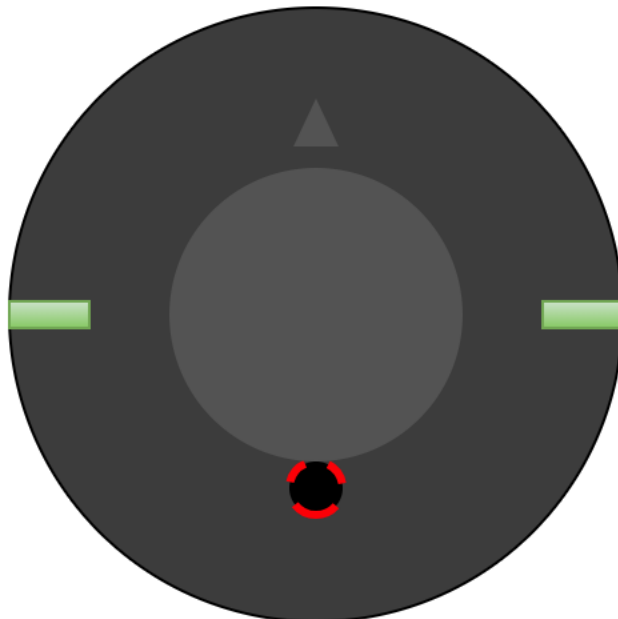
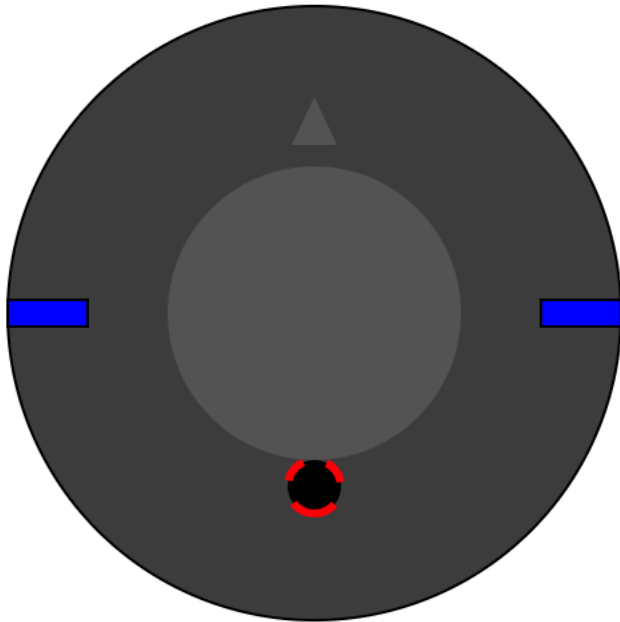



Taking Propellers off of the WISPr Scout:

(1) Press and hold the safety switch until the light flashes white, but if the Safety Switch has not been armed then move to step 2.

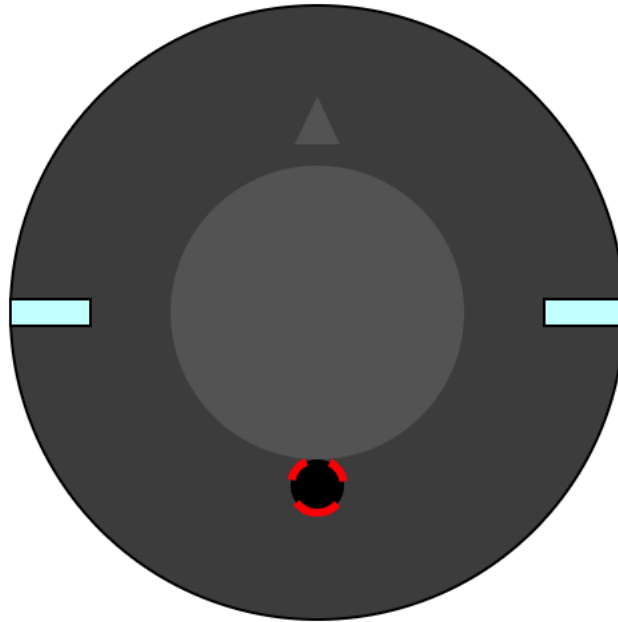

(2) Unplug battery.

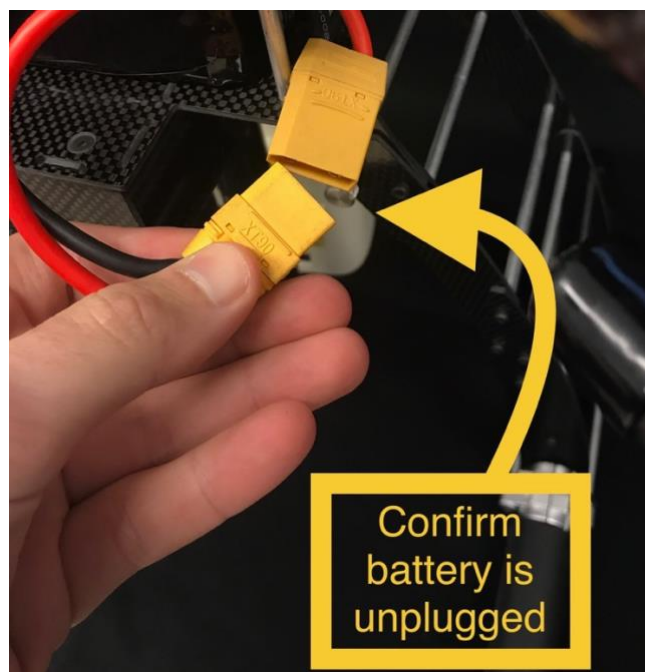



- (3) Disconnect the CCW propeller with the orange quick detach.**
- a. Hold the propeller and spin the motor by hand CW to unscrew and disconnect the CCW propellers.**

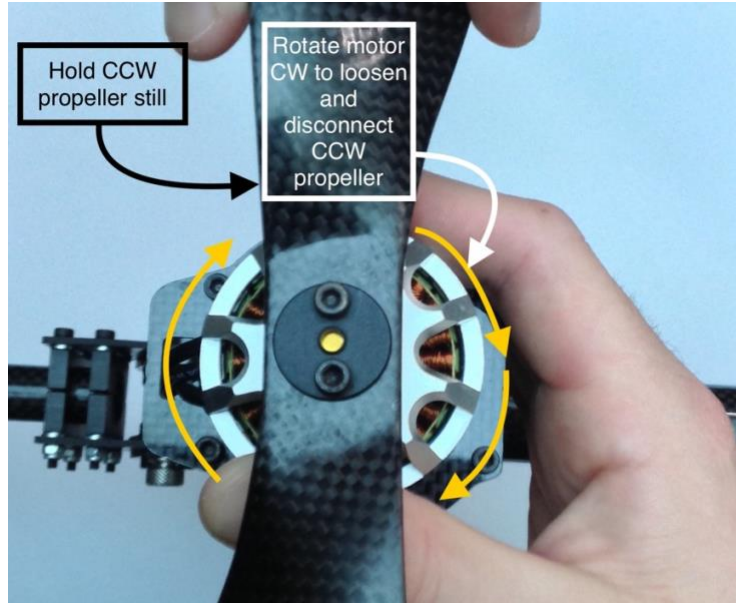



- (4) Disconnect the CW propeller with the silver quick detach.**
- a. Hold the propeller and spin the motor by hand CCW to unscrew and disconnect the CW propellers.**

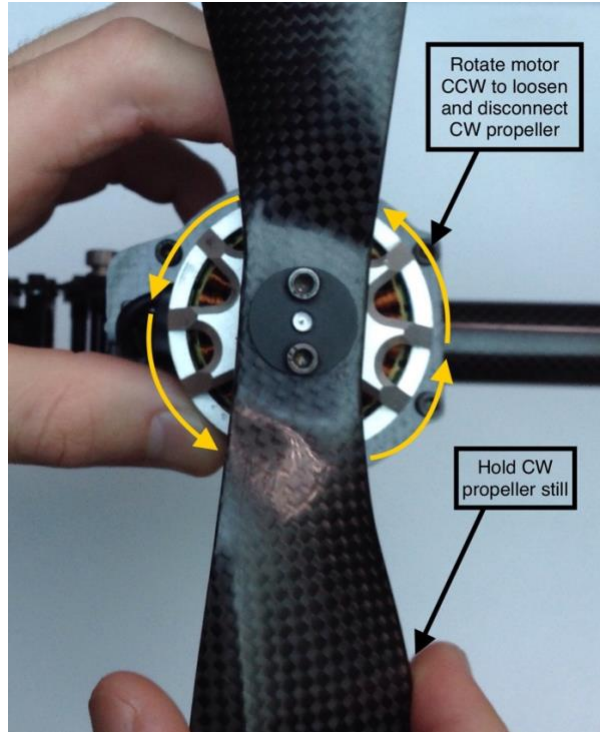

- (5) Fold up propeller bumpers and store the propellers in a safe area.**

